

Standard and HPD Water Pumps

Cool your engine with water...not fuel!

KSE's water pumps are CAD-developed for today's high-performance engines:

- Timing window with four possible locations
- Eight variable inlet port locations
- Indestructible welded tang drive
- Mechanical ceramic seal

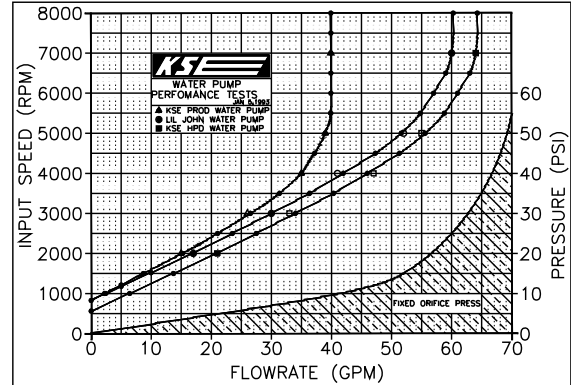

KSD1001



KSD1057

KSE Standard Pump Features

- 1-1/2" inlet fitting
- Two 3/4" NPT outlets
- Cast swept 6-vane impeller
- Designed for engines up to 700 HP

KSD1001

Standard Water Pump Assembly

KSD1044

Water Pump Assembly
1/2" Hex Drive

KSD1086

Water Pump Assembly
1/2" Hex Drive Mopar

KSD1033

Repair Kit for KSD1001 and
KSD1057 Water Pumps



KSE HPD Pump Features

- 1-3/4" inlet fitting
- Two #16 (1") outlets
- Internal-vane dual-scroll impeller for improved efficiency
- Designed for engines over 700 HP
- Higher flow and pressure capability decreases hot spot gasification and creates a higher degree of boundary layer scrubbing, which improves the heat conductivity to the coolant

KSD1057

HPD Water Pump Assembly

KSD1058

HPD Water Pump Assembly
1/2" Hex Drive



Front Covers

With over twenty years of race-proven performance and durability, KSE front covers are preferred by the nation's premier engine builders.

- Compatible with all gear and chain cam drive systems
- Bolt patterns accept all popular dry sump pumps and fuel pumps

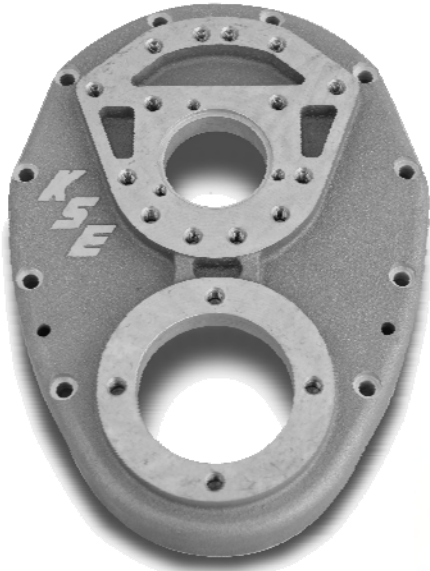

KSD1002
Front Cover, Aluminum
Standard Cam Position



KSD1002M
Front Cover, Magnesium
Standard Cam Position

All Front Cover Components for Small Block Chevy Only



KSD1003
Front Cover, Billet Aluminum
Standard Cam Position
Top Timing Port

KSM5002
Front Cover Timing Port
Aluminum O-Ring Plug



KSM1065
Pan Lip Seal Kit
Pete Jackson and Chain Drive
Cams



KSM1011-200
Water Pump Stud (4 required)



KSD1009
Hose Block Mounts



KSD1027
Water Pump Block-Off
Long



KSD1028
Water Pump Block-Off
Short

STEERING GEARS

TANDEM PUMPS

PULLEYS & DRIVE KITS

POWER STEERING PUMPS

WATER PUMPS & FRONT COVERS

FLUIDS & ACCESSORIES

SERVICES

TECHNICAL INFO

Front Cover Drive Components



KSD1010-051
Front Cam Drive
3/8" hex, 0.515" long

KSD1010-125
Front Cam Drive
3/8" hex, 1.250" long

KSD1010-140
Front Cam Drive
3/8" hex, 1.400" long

KSD1023
Front Cam Drive
1/2" hex, Dry Sump

KSD1023A
Front Cam Drive
1/2" hex, Dry Sump
Pete Jackson/Chain Drive



KSD1011
Crank Drive (Water Pump)
Steel

KSD1011L
Crank Drive (Water Pump)
Aluminum



KSD1093
Crank Drive Big Block Chevy
Aluminum

KSD1032
Crank Drive Shim Kit



KSD1012
Timing Window Cover
Aluminum

KSD1013
Timing Window Cover
Lexan

KSM1020-120
Timing Window O-Ring

STEERING GEARS

TANDEM PUMPS

PULLEYS &
DRIVE KITS

POWER STEERING
PUMPS

WATER PUMPS &
FRONT COVERS

FLUIDS &
ACCESSORIES

SERVICES

TECHNICAL INFO

Water Pump & Front Cover Kits



How to Order:

Create the part number of the kit you need by selecting the desired options in the boxes below and insert their code number into the part number.

Example:

KSD10-22101 is a timing cover kit with an HPD water pump, magnesium cover, two short hose block-offs, a Lexan timing window, and an aluminum crank drive

WAIVER WARRANTY (EXPRESSED OR IMPLIED) NO GUARANTEE

This product and each part thereof, is sold "AS IS" and with all faults. KSE Racing Products, Inc will not be liable for any loss, damage, or injury arising from the use of this product. RACING IS A DANGEROUS ACTIVITY. The user shall determine the suitability and safety of the product for its intended use, and the user assumes all responsibility and risk in connection therewith.

KSD10-

Water Pump Code	Cover Material Code	Hose Block Code	Timing Window Code	Crank Drive Code
1 = Standard Water Pump 2 = HPD Water Pump	0 = Aluminum F/C 1 = Billet Aluminum Standard Cam 2 = Mag F/C No Pan Lip for Most Gear Drives	0 = Hose Mount Blocks 1 = Two Short Block-Offs 2 = One Long and One Short Block-Off	0 = Lexan Timing Window 1 = Aluminum Timing Window Cover Plate	0 = Steel Crank Drive 1 = Aluminum Crank Drive